

No.	Name
1	BL+
2	VSS
3	VDD
4	VDD
5	SCLK
6	SDA

No.	Name	No.	Name
1	NC	11	NC
2	NC	12	VSS
3	NC	13	VSS
4	SDA	14	VSS
5	SCLK	15	NC
6	NC	16	VDD
7	NC	17	NC
8	NC	18	NC
9	NC	19	VDD
10	NC	20	BL+

Specification :

- 1). Driving: Method: STATIC, Vop:5.0V
- 2). Viewing angle: 60'clock
- 3). Display mode: TN/Positive/Transmissive
- 4). Operating temp.: -25° c~+75° C
Storage temp.: -30° c~+80° C
- 5). Backlight : LED, (Y/G)

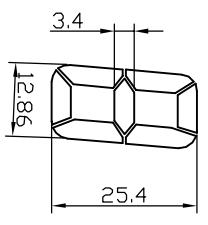

HOT DISPLAY

Dwg Title HTM68227C outline

Dwg No. 1105261450 Date 2010-05-26

Scale	Unit	Tol.	Date
	mm		2010-05-26

Drawn	Checked	Approved
Analyi		