

LN98N10AC

100V N-Channel Power MOSFET

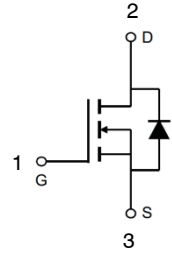
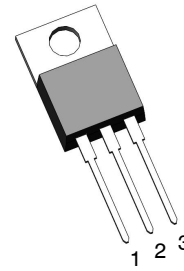

TO220

1. FEATURES

- Low on-resistance and low gate-charge
- Fast switching speed.
- We declare that the material of product compliance with RoHS requirements and Halogen Free.

2. APPLICATIONS

- High-frequency DC-to-DC convertors
- Motor controllers
- Server power

3. DEVICE MARKING AND RESISTOR VALUES

| Device | Marking | Shipping |
|-----------|---------|----------|
| LN98N10AC | 98N10 | 50/Tube |

4. MAXIMUM RATINGS

| Parameter | Symbol | Limits | Unit | |
|--|-----------|-----------|-------|---|
| Drain-to-Source Voltage | VDS | 100 | V | |
| Gate-to-Source Voltage | VGS | ± 20 | V | |
| Continuous Drain Current(Note 1) | ID | TA =25°C | 14 | A |
| | | TA =100°C | 9 | |
| Pulsed Drain Current(Note 2) | IDM | 56 | | |
| Continuous Drain Current | ID | TC =25°C | 149.5 | A |
| | | TC =100°C | 90 | |
| Pulsed Drain Current | IDM | 598 | | |
| Avalanche Current | IAS | 47 | A | |
| Avalanche energy(L=0.1mH) | EAS | 110.5 | mJ | |
| Power Dissipation(Note 1) | PD | TA =25°C | 1.8 | W |
| | | TA =100°C | 0.7 | |
| Power Dissipation | PD | TC =25°C | 125 | W |
| | | TC =100°C | 50 | |
| Operating Junction and Storage Temperature Range | TJ , TSTG | -55~+150 | °C | |

5. THERMAL CHARACTERISTICS

| Parameter | Symbol | Max | Unit |
|-----------------------------|--------|-----|------|
| Junction-to-Ambient(Note 1) | RθJA | 70 | °C/W |
| Junction-to-Case | RθJC | 1 | |

Note:1.Surface mounted on "1.5in x 1.5in" FR4 board using 1*1 in pad, 2 oz Cu.

2.Pulse width limited by maximum junction temperature.

6. ELECTRICAL CHARACTERISTICS

| Characteristic | Symbol | Min. | Typ. | Max. | Unit |
|--|---|---------|------|-----------|------------|
| Static | | | | | |
| Drain to Source Breakdown Voltage (VGS = 0 V, ID = 250 μ A) | BVDSS | 100 | - | - | V |
| Gate-Source Threshold Voltage (VDS = VGS, ID = 250 μ A) | VGS(th) | 2 | - | 4 | V |
| Gate-Body Leakage (VDS = 0 V, VGS = \pm 20 V) | IGSS | - | - | \pm 100 | nA |
| Zero Gate Voltage Drain Current (VDS = 100 V, VGS = 0 V) | IDSS | - | - | 1 | μ A |
| Drain-Source On-Resistance(Note 3) (VGS = 10 V, ID = 50 A) | RDS(on) | - | 4.2 | 4.6 | m Ω |
| Dynamic | | | | | |
| Input Capacitance | (VDS = 50 V, VGS = 0 V, f = 100KHz) | Ciss | - | 2793 | pF |
| Output Capacitance | | Coss | - | 1448 | |
| Reverse Transfer Capacitance | | Crss | - | 28 | |
| Total Gate Charge | (VDS = 50 V, VGS = 10 V, ID = 20 A) | Qg | - | 50 | nC |
| Gate-Source Charge | | Qgs | - | 13.3 | |
| Gate-Drain Charge | | Qgd | - | 14 | |
| Turn-On Delay Time | (VDS = 50 V, ID = 50 A, VGS = 10 V, RG = 3 Ω) | td(on) | - | 24 | ns |
| Rise Time | | tr | - | 27 | |
| Turn-Off Delay Time | | td(off) | - | 43 | |
| Fall Time | | tf | - | 21 | |
| Gate Resistance (VDS = 0 V, VGS = 0 V, f = 1.0MHz) | Rg | - | 15 | - | Ω |
| Diode characteristics | | | | | |
| Continuous Current TC =25° C | IS | - | - | 149.5 | A |
| Plused Current TC =25° C | ISM | - | - | 598 | A |
| Diode Forward Voltage (IS = 10 A, VGS = 0 V) | VSD | - | 0.8 | 1.3 | V |
| Reverse Recovery Time (VR=50V, IF=10A, dIF/dt=100A/us) | trr | - | 101 | - | ns |
| Reverse Recovery Charge (VR=50V, IF=10A, dIF/dt=100A/us) | Qrr | - | 200 | - | nC |
| Reverse Recovery Current (VR=50V, IF=10A, dIF/dt=100A/us) | IRRM | - | 4 | - | A |

3.Pulse test: PW \leq 300us duty cycle \leq 2%.

7. ELECTRICAL CHARACTERISTICS CURVES

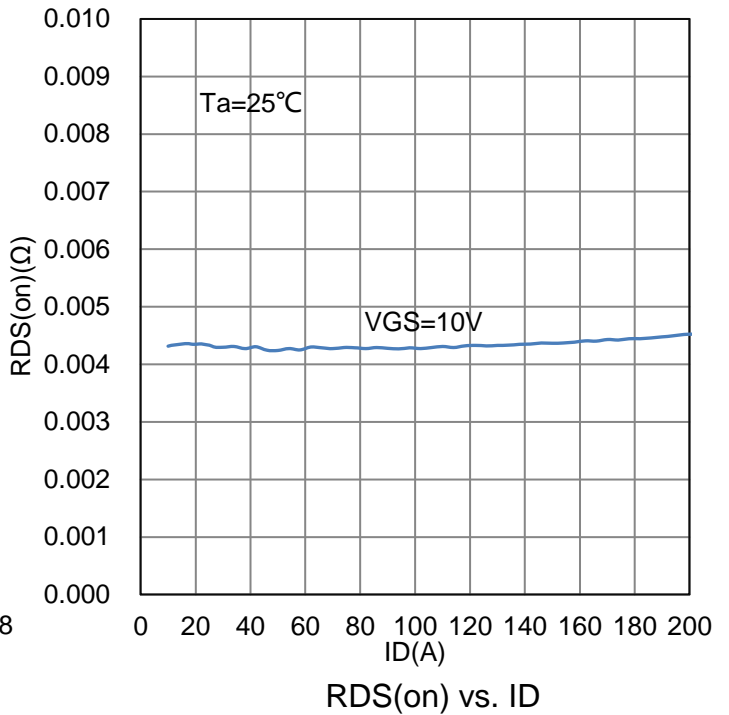
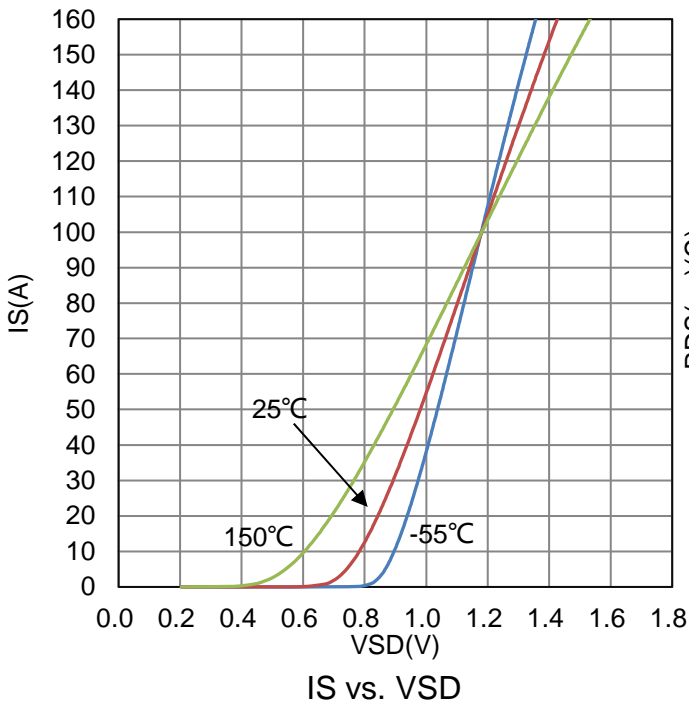
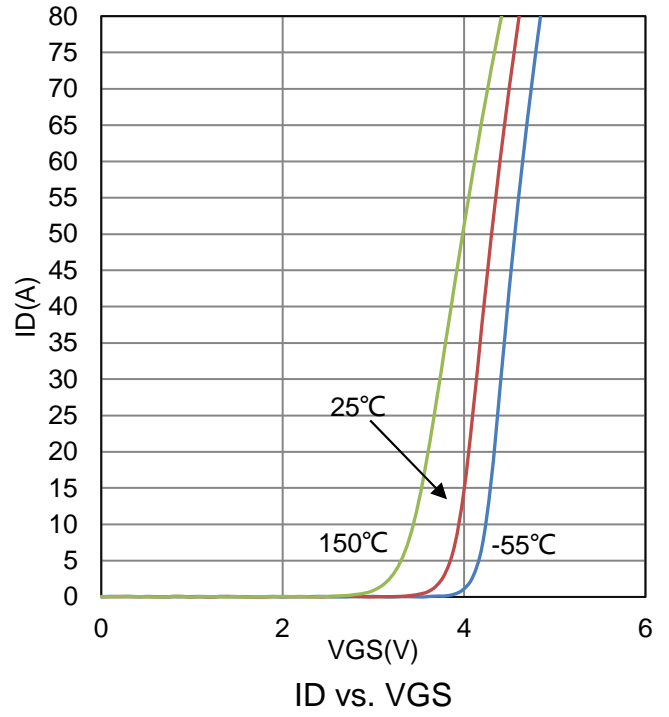
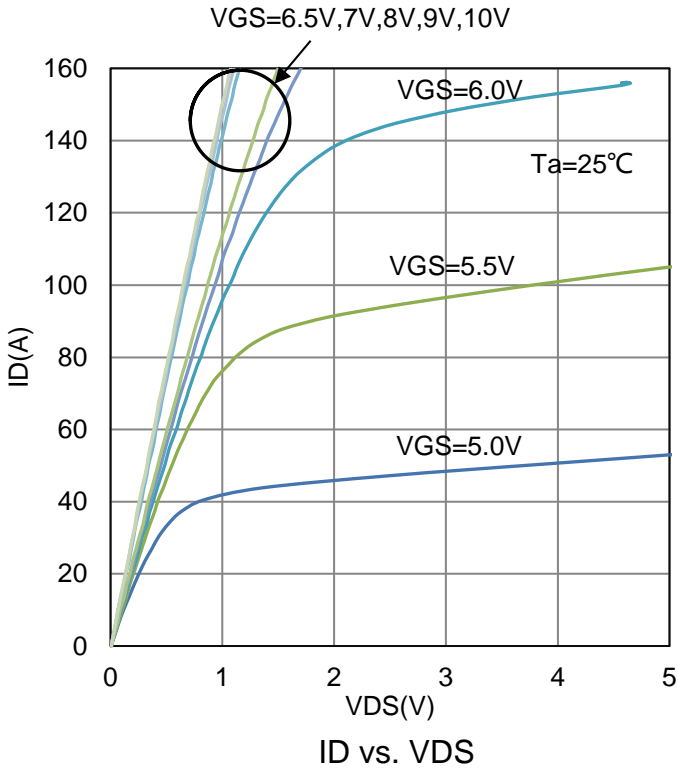

7. ELECTRICAL CHARACTERISTICS CURVES(Con.)

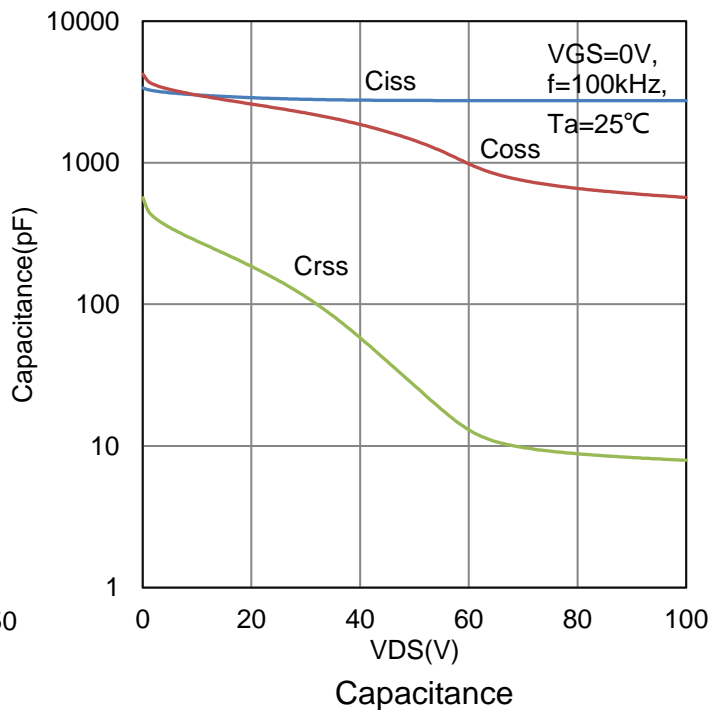
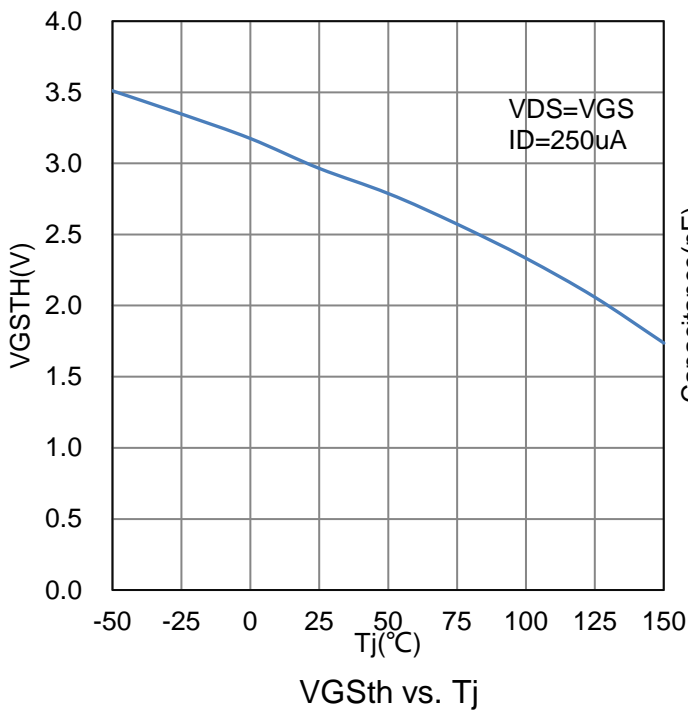
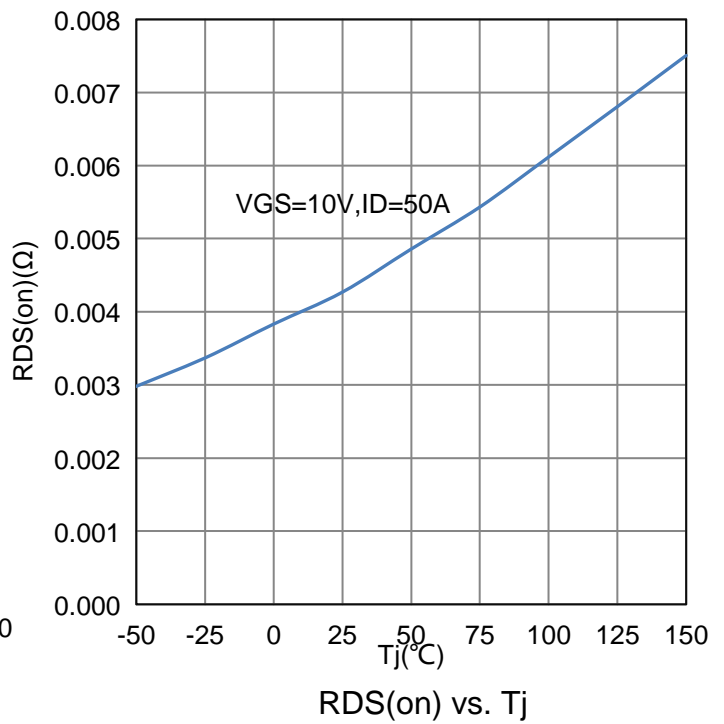
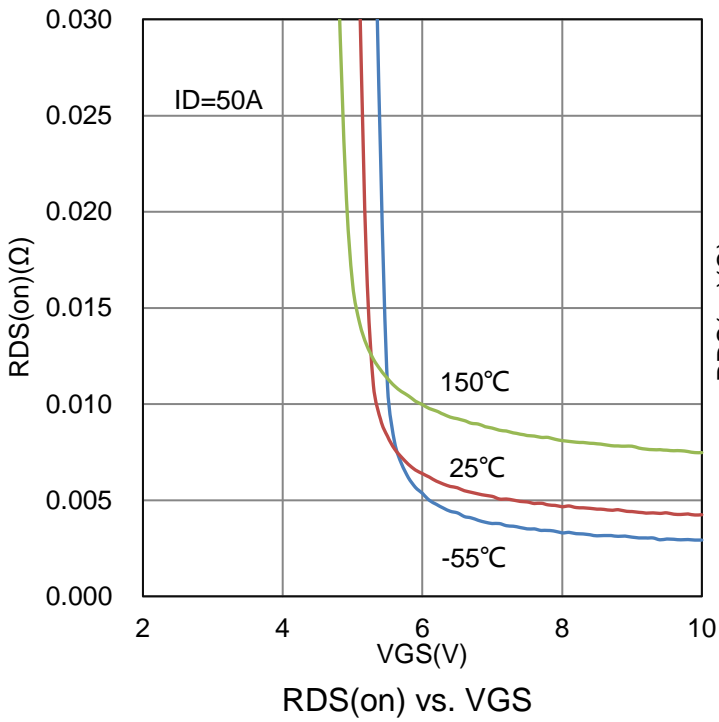

7. ELECTRICAL CHARACTERISTICS CURVES(Con.)

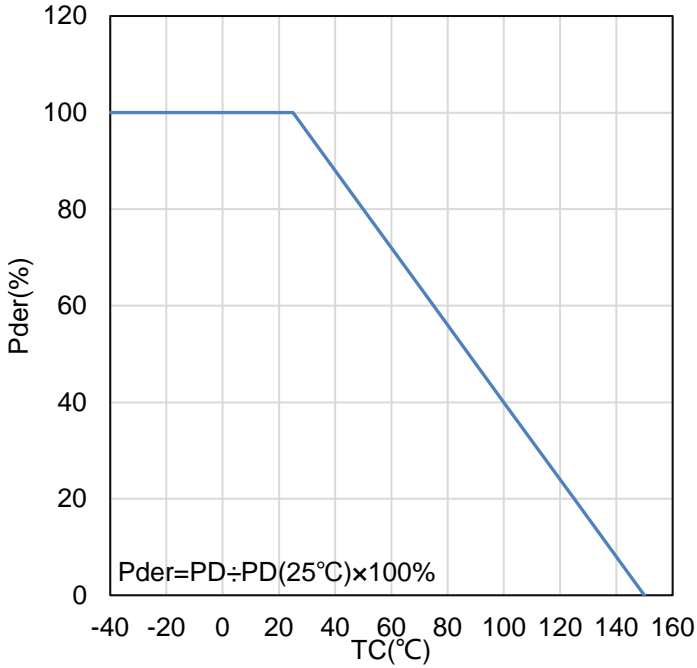

Normalized Derating Curve

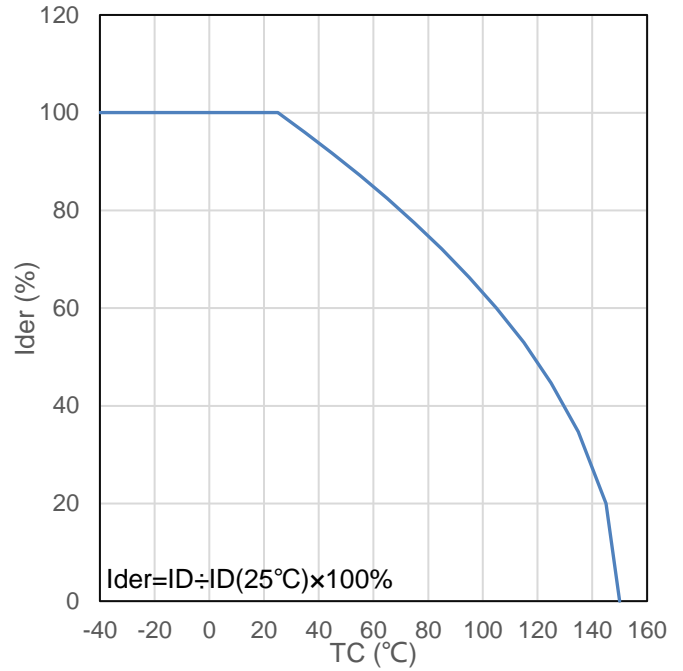

Normalized drain Current

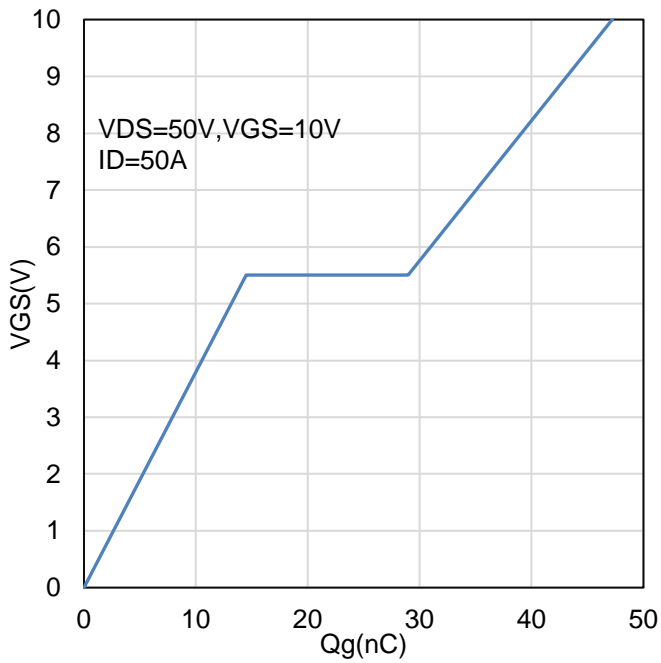

VGS vs. Qg

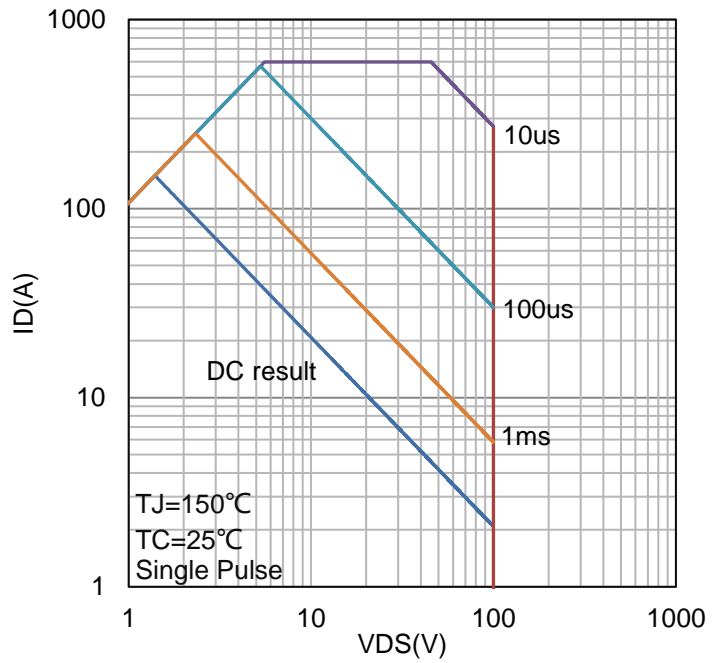

Safe Operating Area

7. ELECTRICAL CHARACTERISTICS CURVES(Con.)

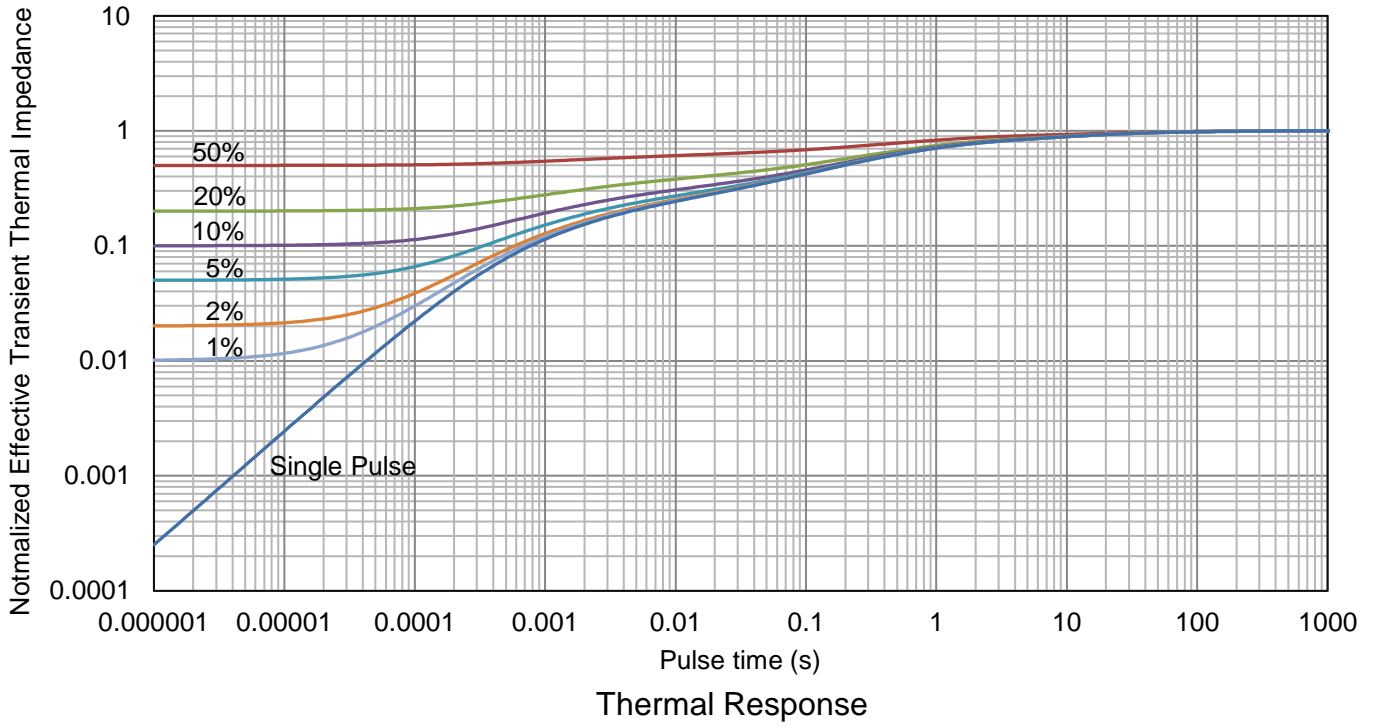

8.OUTLINE AND DIMENSIONS

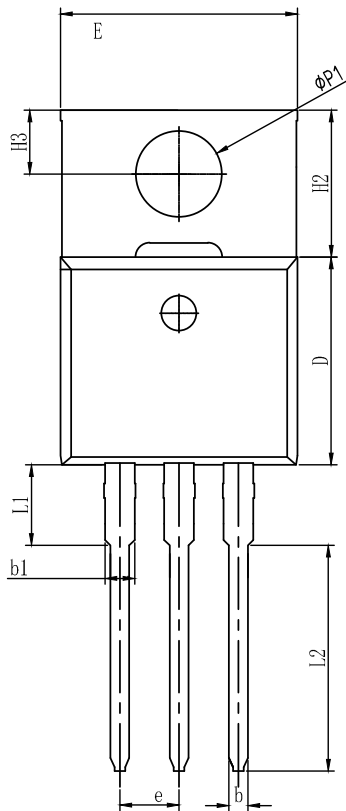

TOP VIEW

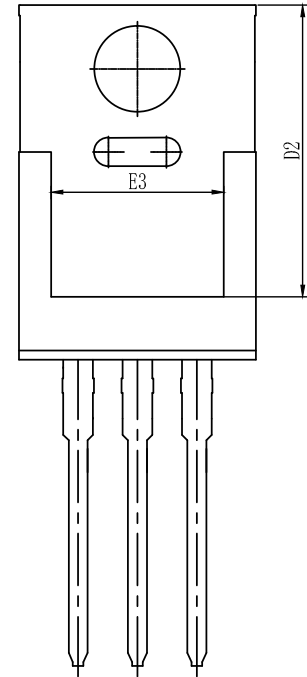
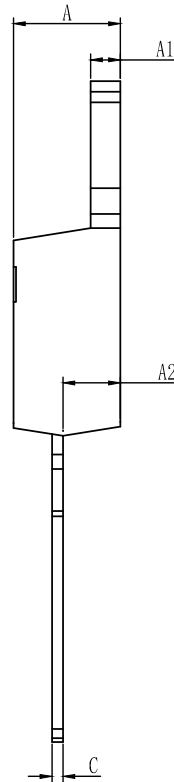

BOTTOM VIEW

GENERAL NOTES

1. Top package surface finish Max Ra1,2±0.2um
2. Bottom package surface finish MAX Ra02um
3. Protrusion or Gate Burrs shall not exceed 0.05mm per side.
4. Off center Max0.05mm; Mismatch Max 0.05mm.

| DIM | MILLIMETERS | | |
|-----|-------------|-------|-------|
| | MIN | NOM | MAX |
| A | 4.42 | 4.57 | 4.72 |
| A1 | 1.20 | 1.30 | 1.40 |
| A2 | 2.35 | 2.45 | 2.55 |
| b | 0.73 | 0.83 | 0.93 |
| b1 | 1.20 | 1.30 | 1.40 |
| c | 0.41 | 0.48 | 0.58 |
| D | 8.70 | 8.90 | 9.10 |
| D2 | 12.20 | 12.50 | 12.80 |
| E | 9.85 | 10.15 | 10.45 |
| E3 | 7.10 | 7.40 | 7.70 |
| e | 2.54BSC | | |
| H2 | 6.10 | 6.30 | 6.50 |
| H3 | 2.54 | 2.74 | 2.94 |
| L1 | 3.16 | 3.46 | 3.76 |
| L2 | 9.36 | 9.66 | 9.96 |
| ØP1 | 3.48 | 3.68 | 3.88 |

DISCLAIMER

- Curve guarantee in the specification. The curve of test items with electric parameter is used as quality guarantee. The curve of test items without electric parameter is used as reference only.
- Before you use our Products for new Project, you are requested to carefully read this document and fully understand its contents. LRC shall not be in any way responsible or liable for failure, malfunction or accident arising from the use of any LRC's Products against warning, caution or note contained in this document.
- All information contained in this document is current as of the issuing date and subject to change without any prior notice. Before purchasing or using LRC's Products, please confirm the latest information with a LRC sales representative.