

# LFR16E60SAC

## Fast Recovery Diode

### 1. FEATURES

- We declare that the material of product compliance with RoHS requirements and Halogen Free.
- Plastic package has Underwriters Laboratory Flammability Classification 94 V-0
- Low leakage current
- Fast recovery time

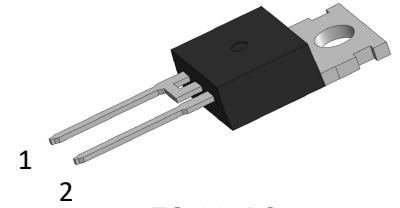

TO-220AC

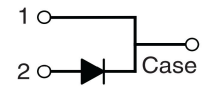

Case Positive

### 2. DEVICE MARKING AND ORDERING INFORMATION

Device	Marking	Shipping
LFR16E60SAC	LFR16E60S	50pcs/Tube

### 3. MAXIMUM RATINGS(Tc=25°C)

Parameter	Symbol	Limit	Unit
Maximum Repetitive Peak Reverse Voltage	VRRM	600	V
Maximum RMS Voltage	VRMS	420	V
Maximum DC Blocking Voltage	VR	600	V
Average Forward Current (Tc=115°C, Duty Cycle=0.5)	IF(AV)	16	A
Peak Forward Surge Current 8.3ms Single Half Sine Wave Superimposed On Rated Load	IFSM	200	A
Operation Junction And Storage Temperature Range	TJ,TSTG	-55 ~ +150	°C
Typical Thermal Resistance	RθJC	1.5	°C/W

### 4. ELECTRICAL CHARACTERISTICS

Characteristic	Symbol	Conditions	Min	Typ	Max	Unit
Forward Voltage	VF	IF=16A, Tj=25°C			1.7	V
		IF=16A, Tj=125°C			1.6	V
Reverse Leakage Current	IR	VR=600V, Tj=25°C			10	μA
		VR=600V, Tj=125°C			400	μA
Reverse Recovery Time	Trr	IF=0.5A, IR=1A, IRR=0.25A, Tj=25°C			40	ns

**5. OUTLINE AND DIMENSIONS**

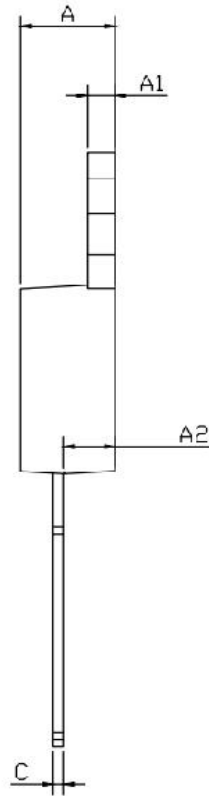
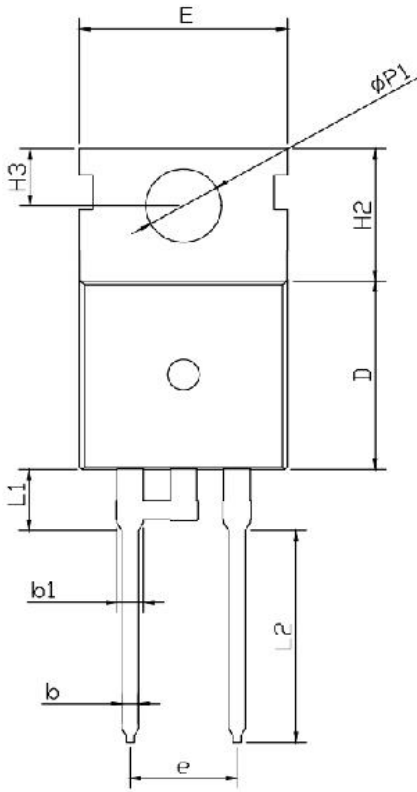

TO-220AC			
DIM	MIN	NOR	MAX
A	4.40	4.50	4.60
A1	1.20	1.30	1.40
A2	2.20	2.40	2.60
b	0.70	0.80	0.90
b1	1.15	1.25	1.35
C	0.40	0.50	0.60
D	9.00	9.20	9.40
D2	13.3REF		
E	9.70	10.00	10.30
E3	8.0REF		
e	4.98	5.08	5.18
H2	6.20	6.50	6.80
H3	2.60	2.80	3.00
L1	2.80	3.10	3.40
L2	10.00	10.30	10.60
ΦP1	3.50	3.60	3.70
Dimensions are in mm			

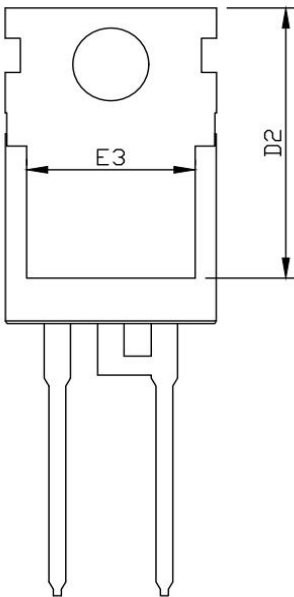

**DISCLAIMER**

- Curve guarantee in the specification. The curve of test items with electric parameter is used as quality guarantee. The curve of test items without electric parameter is used as reference only.
- Before you use our Products for new Project, you are requested to carefully read this document and fully understand its contents. LRC shall not be in any way responsible or liable for failure, malfunction or accident arising from the use of any LRC's Products against warning, caution or note contained in this document.
- All information contained in this document is current as of the issuing date and subject to change without any prior notice. Before purchasing or using LRC's Products, please confirm the latest information with a LRC sales representative.
- First edition: The information contained in this document is provided on an "as is" basis and LRC does not warrant that all information contained in this document is accurate and/or error-free. LRC shall not be in any way responsible or liable for any damages, expenses or losses incurred by you or third parties resulting from inaccuracy or errors of or concerning such information.