

## 60A,250V 玻璃钝化快恢复二极管 60A,250V Glass Passivated Fast Recovery Diode

### ■特征 Features

- 超快恢复时间  
Ultra fast Recovery Times
- 软恢复特性  
Soft Recovery Characteristics
- 低正向电压  
Low Forward Voltage
- 低漏电流  
Low Leakage Current

关键参数 KEY PARAMETERS		
参数 PARAMETER	数值 VALUE	单位 UNIT
$I_{F(AV)}$	60	A
$V_{RRM}$	250	V
$I_{FSM}$	800	A
Package	TO-3P	

### ■应用范围 Applications

- 开关电源  
Switch mode Power Supply
- 逆变器  
Inverters
- 续流二极管  
Free Wheeling Diode
- 电机控制器  
Motor Controllers
- 变频器  
Converters
- 功率因数校正  
PFC

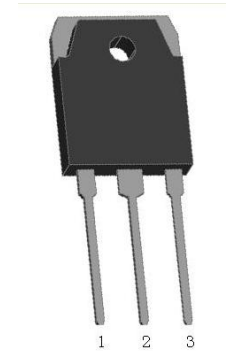
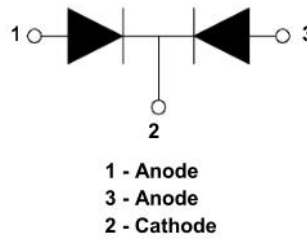

### ■最大额定值 Maximum Ratings @ Ta = 25°C unless otherwise noted

特征参数/测试条件 Characteristic / Test Conditions	符号 SYMBOL	S2FD60B25 E	单位 UNIT
反向重复峰值电压 Maximum recurrent peak reverse voltage	$V_{RRM}$	250	V
平均整流输出电流 Average rectified output current	$I_{(AV)}$	60 (30*2)	A
T <sub>C</sub> =100°C			
最大正向浪涌电流, 8.3 ms 单半正弦波叠加在额定负载上 Peak surge forward current, 8.3 ms single half sine-wave superimposed on rated load	$I_{FSM}$	800	A
结温 Junction temperature	T <sub>J</sub>	-55~+150	°C
存储温度 Storage temperature	T <sub>STG</sub>	-55~+150	°C
结电容 Junction capacitance @4V,1MHz	C <sub>J</sub>	800	pF
引脚可承受温度 (10s) Lead Temperature for 10 Sec	TL	260	°C

■电性特性 Electrical Characteristics @ Ta = 25°C unless otherwise noted

参数 PARAMETER	条件 CONDITIONS	符号 SYMBOL	标准值 Typ	最大值 Max	单位 UNIT
正向峰值电压 Peak Forward Voltage	IF=30.0A, Tj=25°C	VF	0.93	1.0	V
	IF=30.0A, Tj=125°C		0.78	0.83	V
反向峰值电流 Peak Reverse Current	VR=VRRM, 脉冲测试, 单个二极管的额定值 VR=VRRM, Pulse measurement, Rating of per diode	Tj=25°C	/	5	μA
		Tj=125°C	/	100	
反向恢复时间 Reverse Recovery Time	IF=0.5A, IRM=1A, IRR=0.25A, TC=25°C	Trr	48	50	ns

■热特性 Thermal Characteristics @ Ta = 25°C unless otherwise noted

参数 PARAMETER	符号 SYMBOL	额定值 RATED VALUE	单位 UNIT
结到壳体的热阻, 带散热器 Junction-to-case thermal resistance with heat sink	Rθjc	0.8	°C/W

■特性曲线 Characteristic Curve

FIG.1 . Derating Curve For Output Rectified Current

图 1. 电流降额曲线

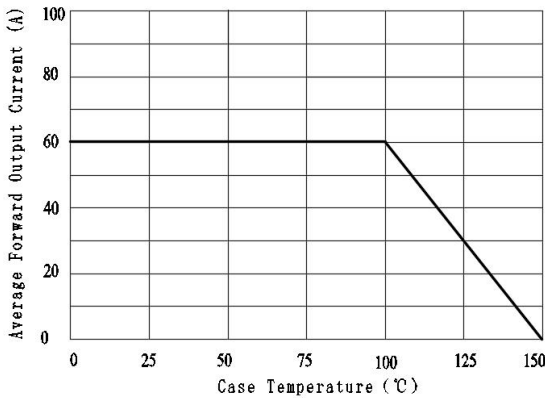

FIG.3. Typical Reverse Characteristics Per Bridge Element

图 3. 典型反向特性

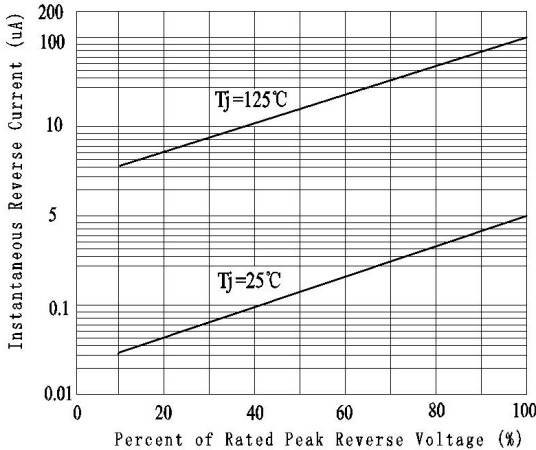

FIG.2 . Maximum Non-Repetitive Peak Forward Surge Current Per Bridge Element

图 2. 最大正向不重复峰值浪涌电流

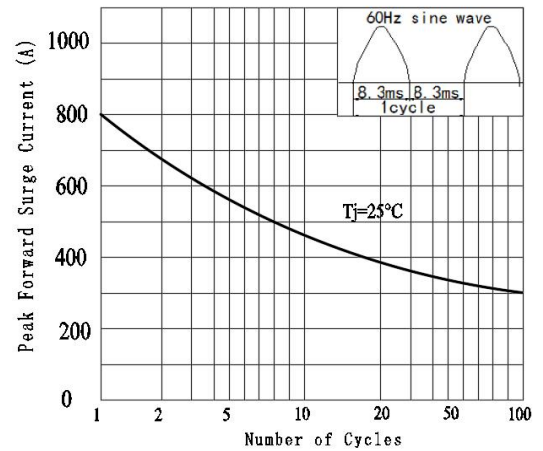

FIG.4. Typical Forward Characteristics Per Bridge Element

图 4. 典型正向特性

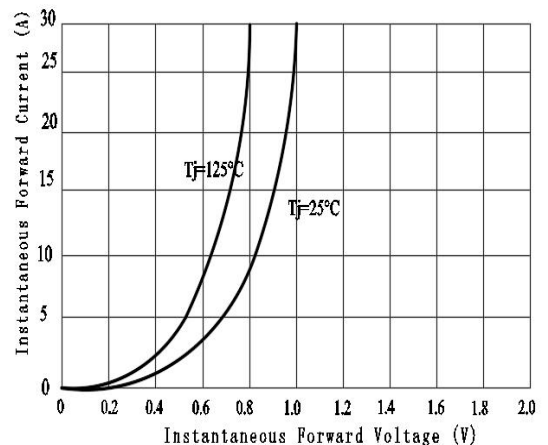
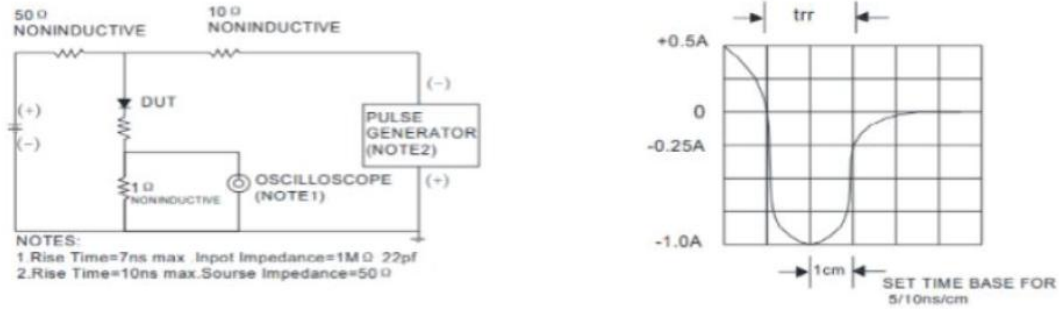

FIG.5. Diode Reverse Recovery Test Circuit and Waveform

图 5. 二极管反向恢复测试电路及波形



■ 标记图 Marking Diagram

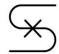

 : 希尔LOGO

S2FD60B25 E: 标识代码

NHA001: 产品批次码

■ 尺寸图 Dimension Drawing

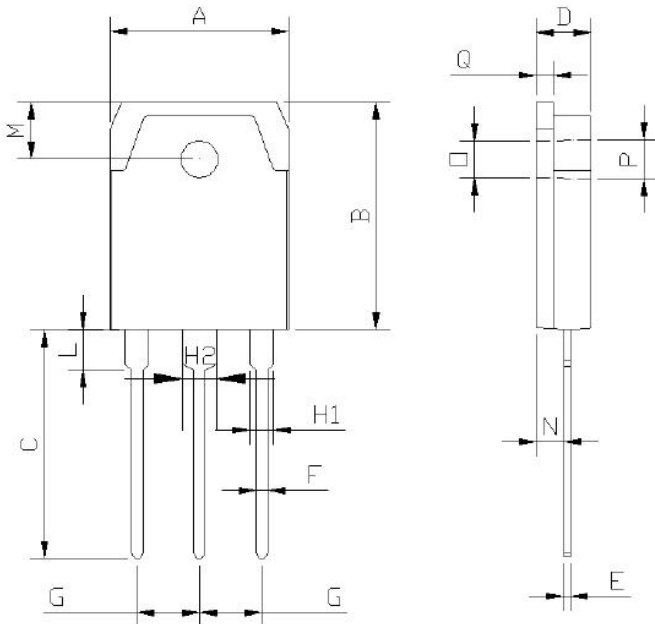

Dim.	Millimeter		Inches	
	min	max	min	max
A	15.1	16.1	0.594	0.634
B	19.4	20.4	0.764	0.803
C	19	20	0.748	0.787
D	4.3	5.3	0.169	0.209
E	0.4	0.8	0.016	0.031
F	0.8	1.2	0.031	0.047
G	5.25	5.65	0.207	0.222
H1	1.8	2.2	0.071	0.087
H2	2.8	3.2	0.110	0.126
L	2.7	3.1	0.106	0.122
M	4.7	5.3	0.185	0.209
N	2.2	2.6	0.087	0.102
O	3	3.3	0.118	0.130
P	3.3	3.6	0.130	0.142

Notice

Unless otherwise specified in the data sheet, the product is designed and qualified as a standard commercial product and is not intended for use in applications that require extraordinary levels of quality and reliability, such as automotive, aviation/aerospace and life-support devices or systems. Any and all semiconductor products have certain probability to fail or malfunction, which may result in personal injury, death or property damage. Customer are solely responsible for providing adequate safe measures when design their systems. Leshan Share Electronic Co., Ltd. reserves the right to improve product design, function and reliability without notice.