

Rotary Cylinder

SDRJ-16,20,25,30,40,50,63

特性

- 两个气缸同时发生推力的双推力型
- 设计成中空轴、达到空气接口及工件连接的方便性
- 与旋转力相同停止力的实时控制停止系统
- 使用固定的轴销螺栓、Key的Bracket等游隔最小化结构
- 为发挥最大功能、适用合理的要素
- SDRJ全部产品附着缓冲器(选择Rubber)

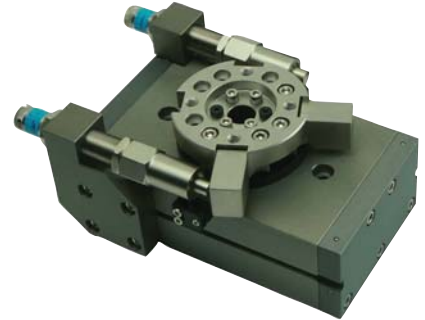

Rack & Pinion Type

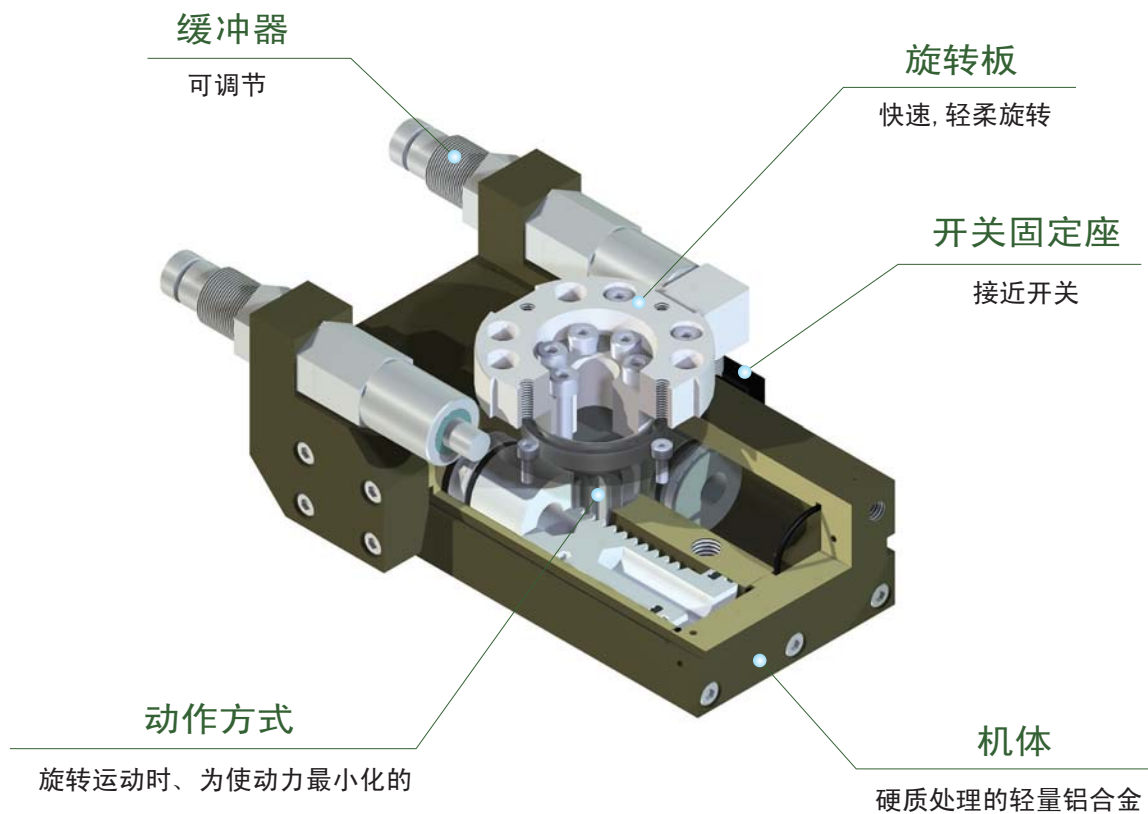

SDRJ

部品分解图

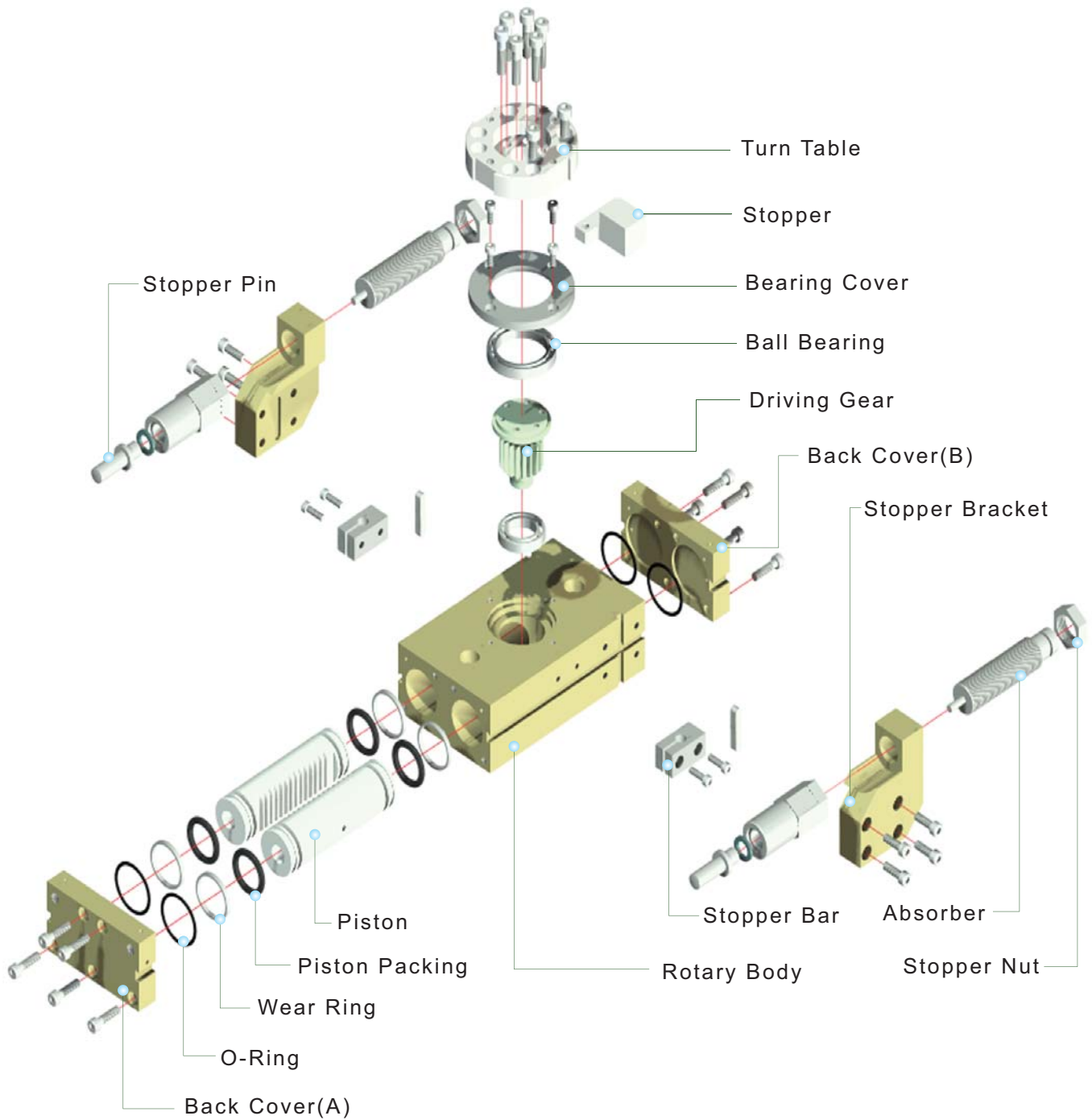

SDRJ

订购记号

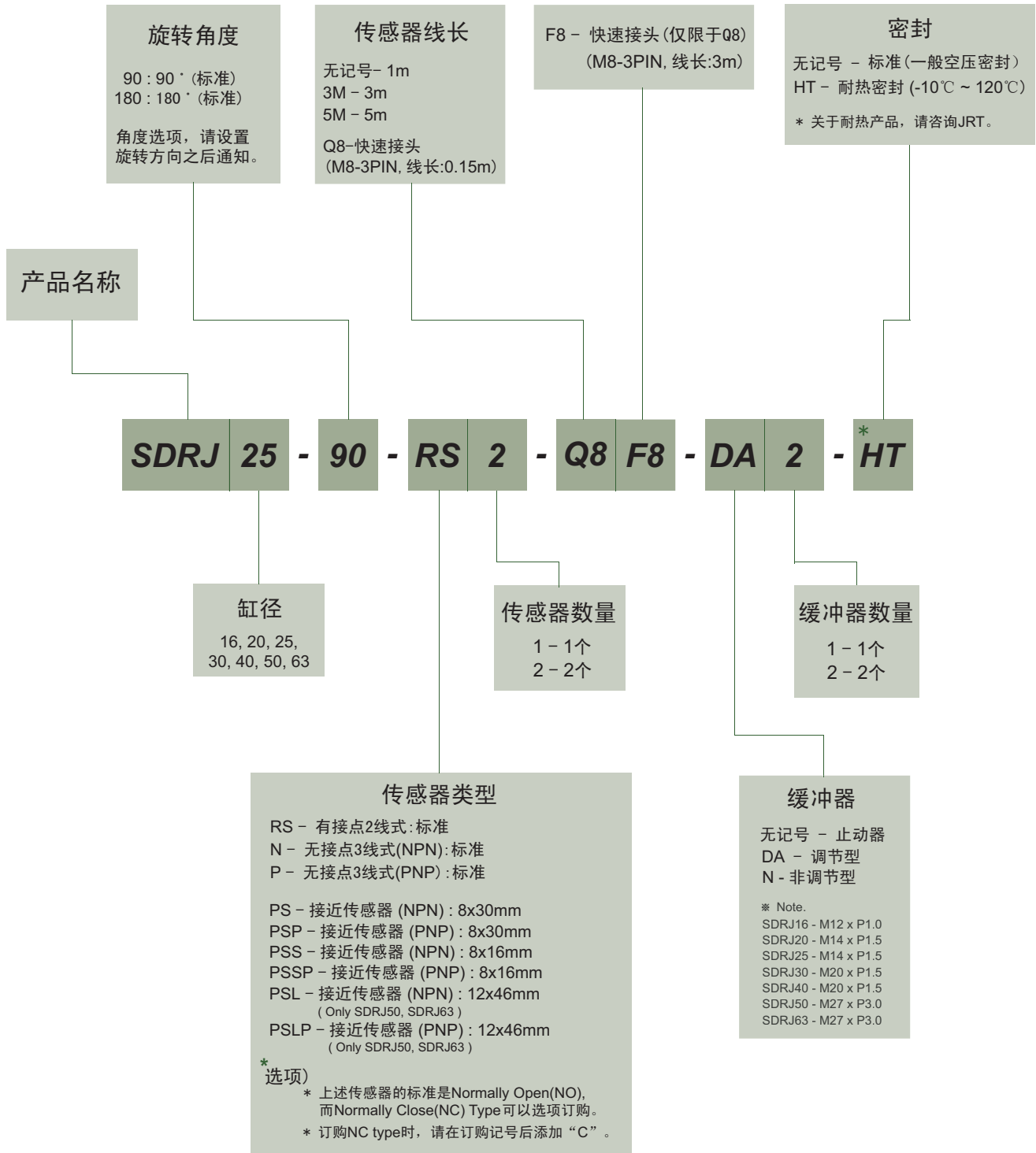

※ 带*号产品的交货期比标准产品长, 订货时请咨询JRT公司。

SDRJ

产品规格

P : 空气压力[bar]

产品名称	SDRJ16	SDRJ20	SDRJ25	SDRJ30	SDRJ40	SDRJ50	SDRJ63	Unit
有效力矩	0.235P	0.49P	1.039P	1.49P	3.165P	6.448P	14.7P	N·m
轴直角负荷	8	12	15	16	26	32	42	Kg
轴方向压缩负荷	8	10	14	16	25	30	40	Kg
轴方向拉伸负荷	7	9	10	12	20	26	32	Kg
产品重量 (90°)	0.86	2.15	2.74	3.88	6.82	11.66	22.90	Kg
产品重量 (180°)	0.82	2.11	2.66	3.76	6.62	11.60	22.50	Kg
旋转时间 (90°)	0.2 to 1.4	0.2 to 1.8	0.2 to 1.8	0.3 to 1.0	0.4 to 1.2	0.6 to 3.2	0.7 to 3.5	sec
旋转时间 (180°)	0.3 to 1.0	0.3 to 1.0	0.3 to 1.0	0.4 to 1.2	0.5 to 1.4	0.7 to 3.5	0.8 to 3.7	sec
排管连接口	M5	PF(G) 1/8	PF(G) 1/8	PF(G) 1/8	PF(G) 1/8	PF(G) 1/8	PF(G) 1/4	
空气消耗量(90°/180°)	8.8 / 17.7	19.7 / 39.5	41.6 / 83.2	66.6 / 119.9	126.3 / 252.5	251.3 / 502.7	589.8/1179.6	cm ³
缓冲装置	Stopper or Absorber							
重复位置精度	±0.1							degree
使用压力	3 to 7							bar
周围温度	-5 to 60							°C
润滑	不必要							

* After 100 consecutive strokes to end positions

SDRJ-16

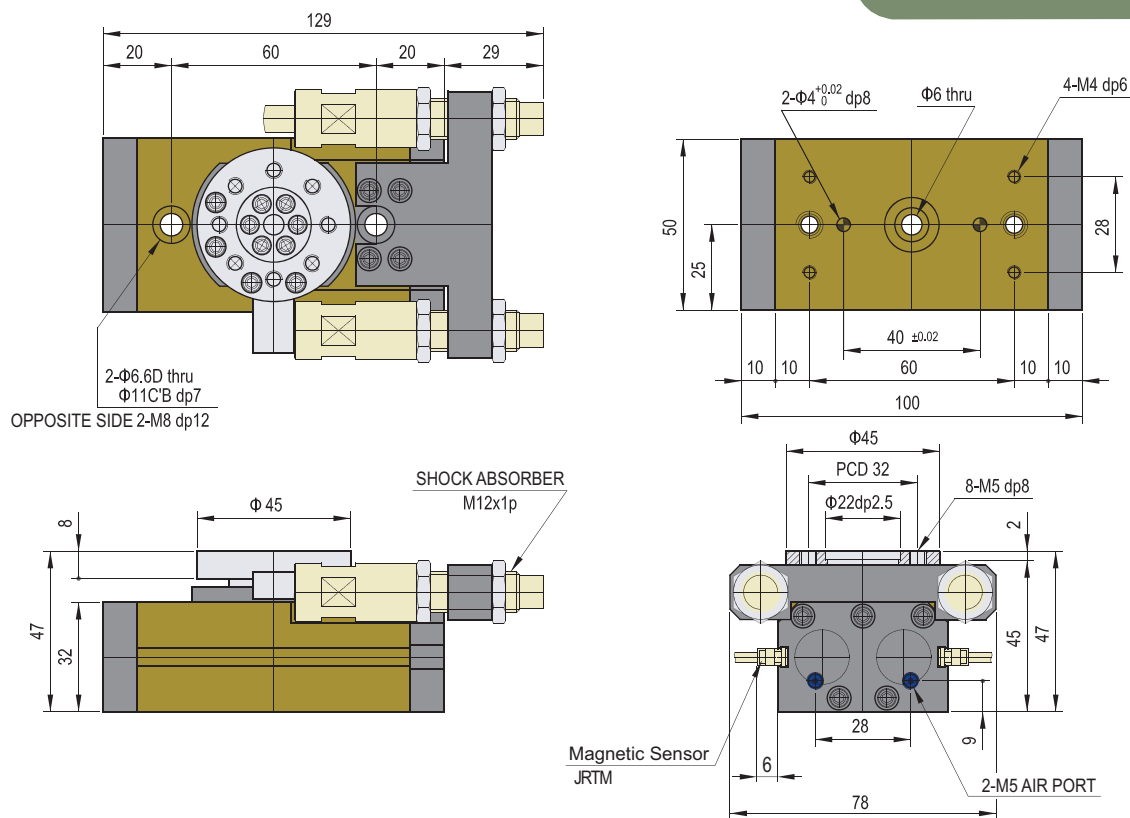

SDRJ

SDRJ-20

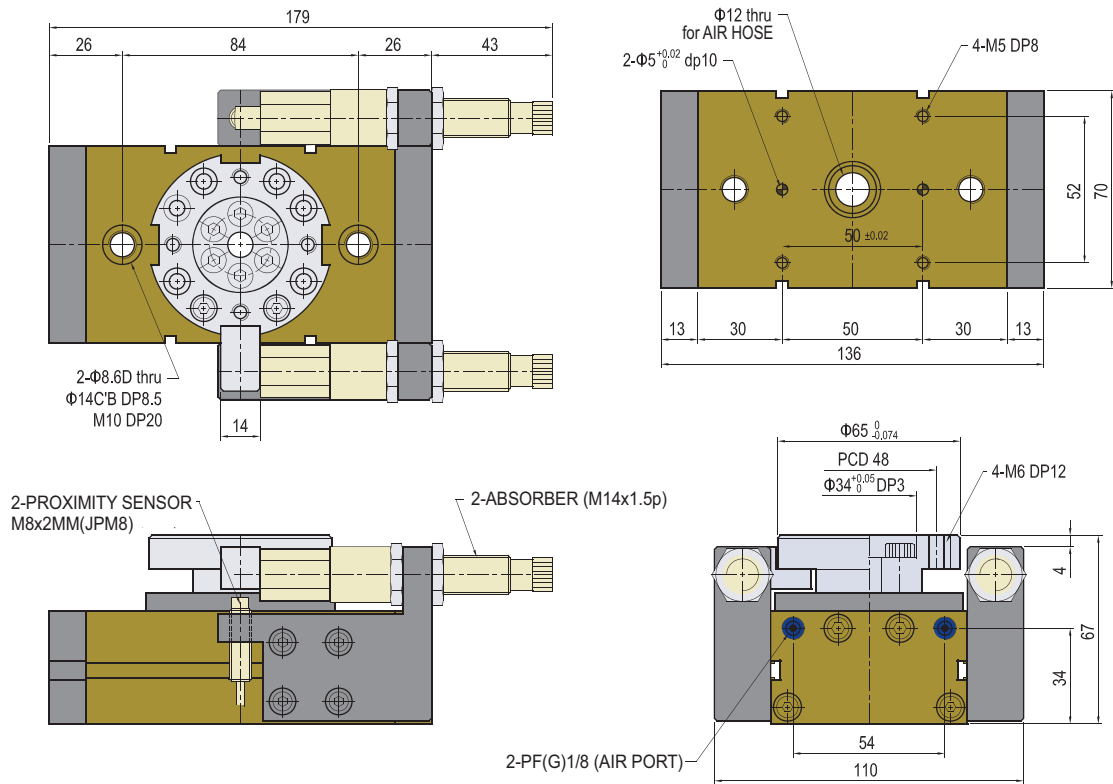

SDRJ-25

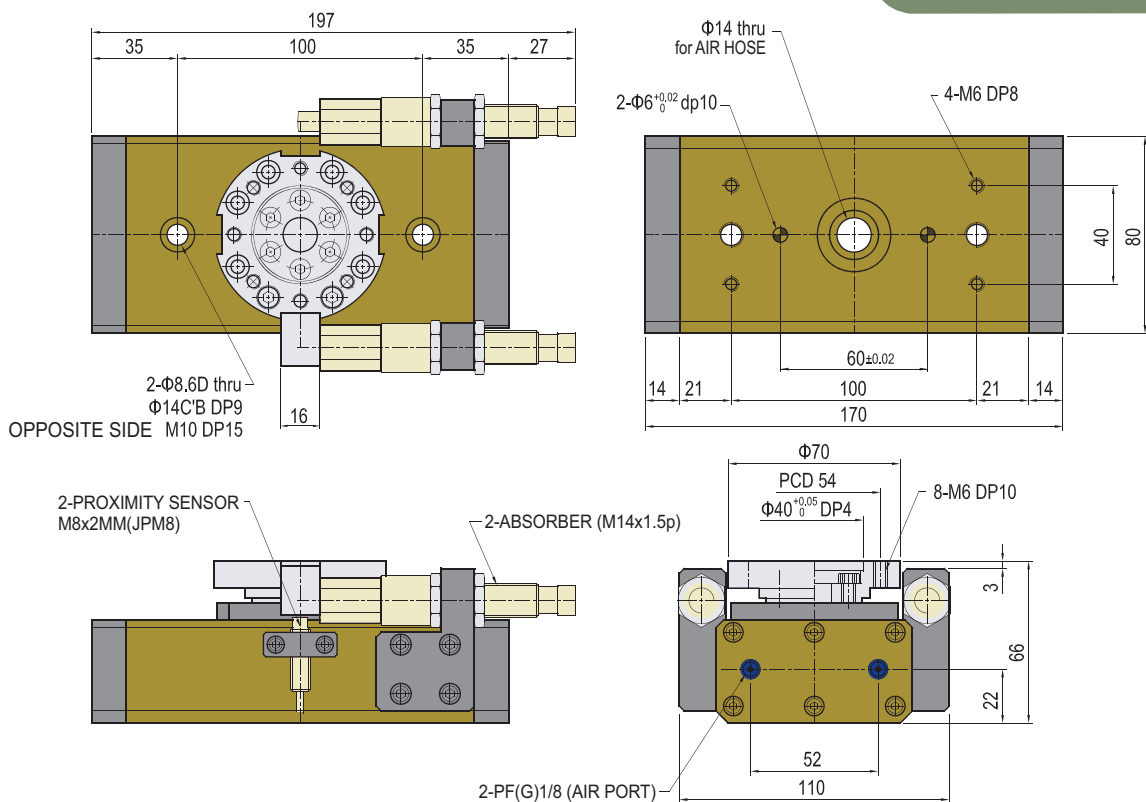

SDRJ

SDRJ-30

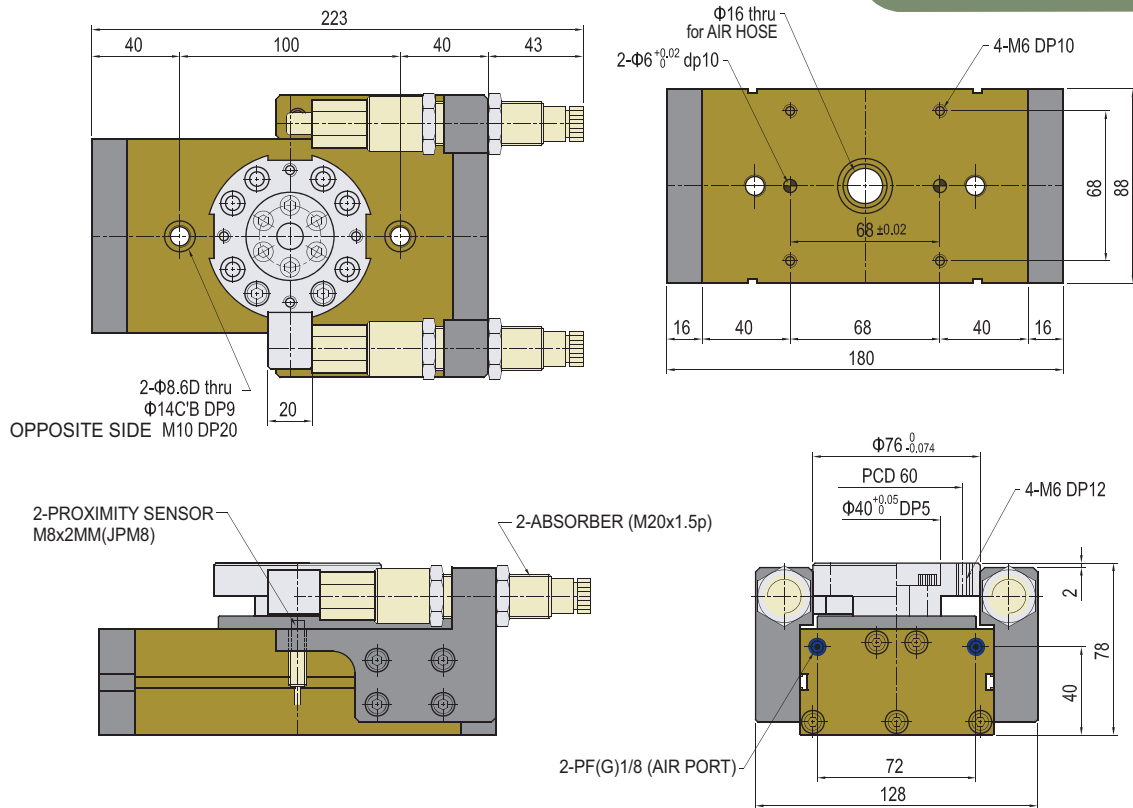

SDRJ-40

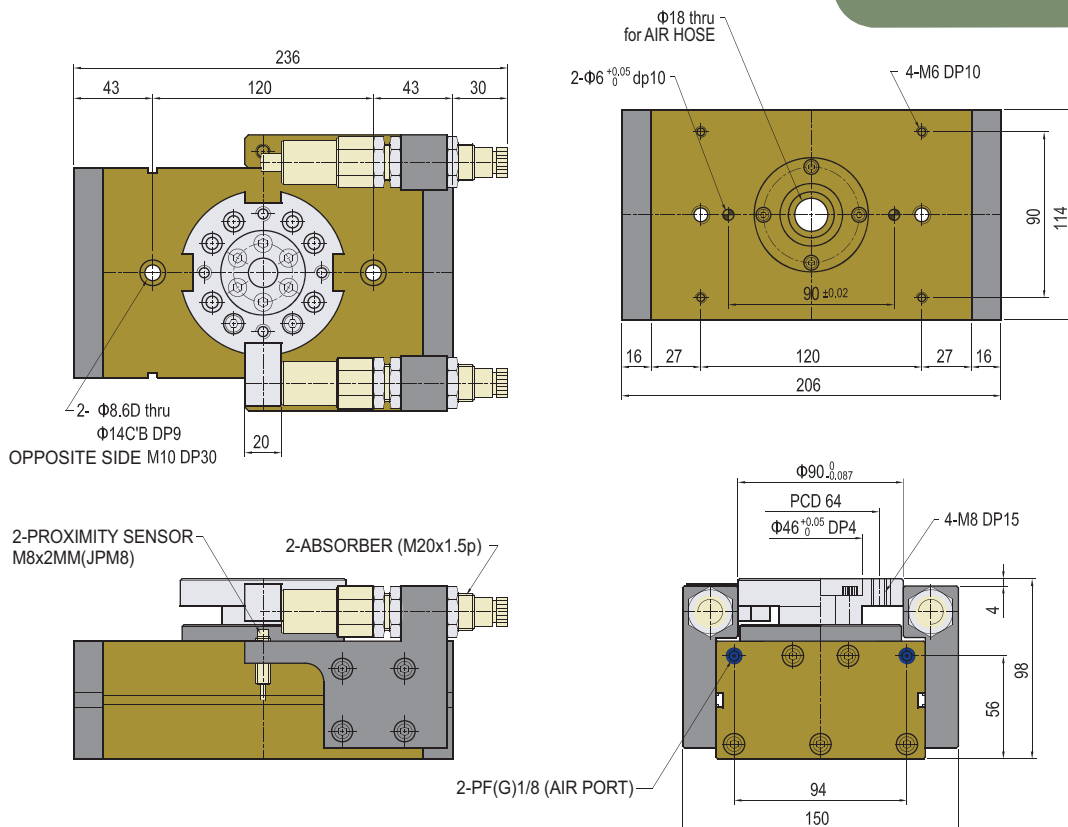

SDRJ

SDRJ-50

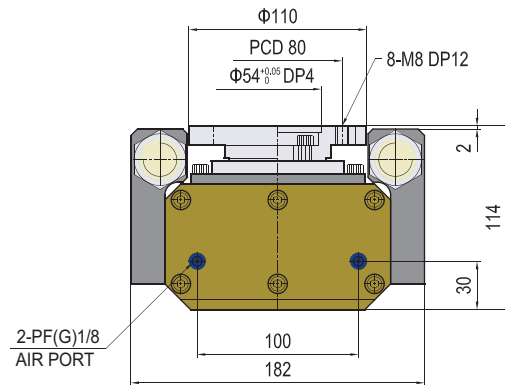
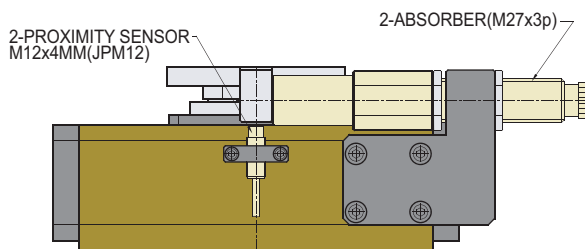
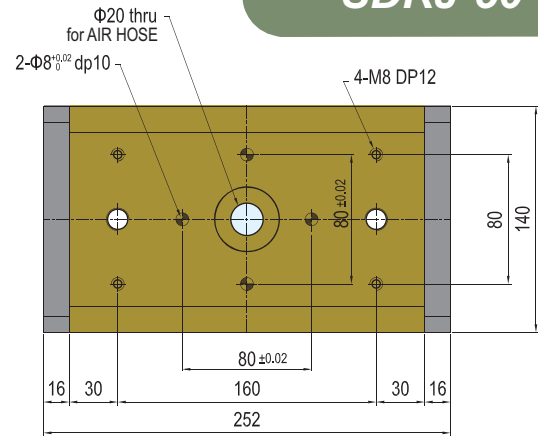
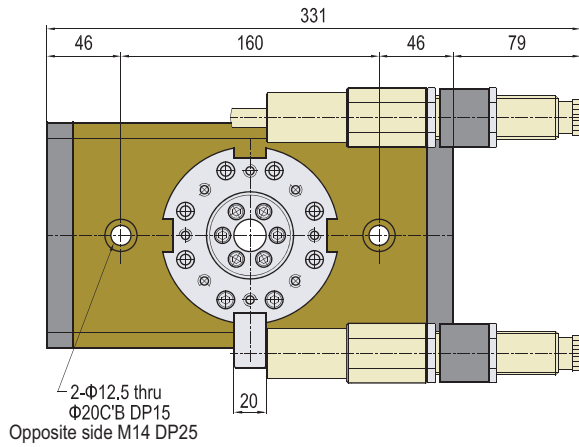

SDRJ-63

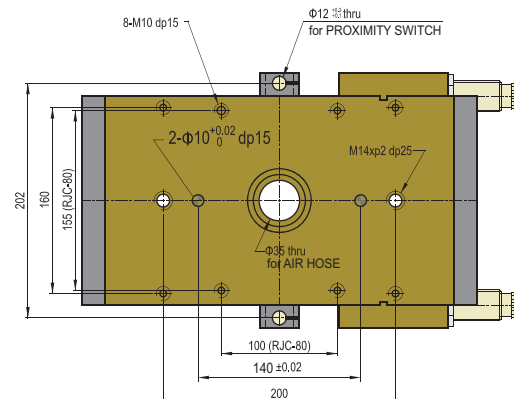
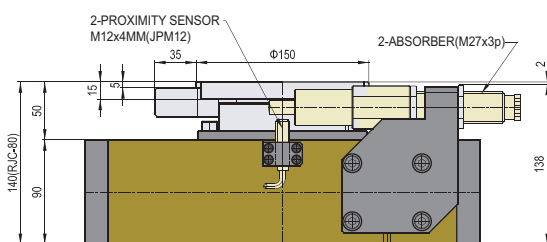
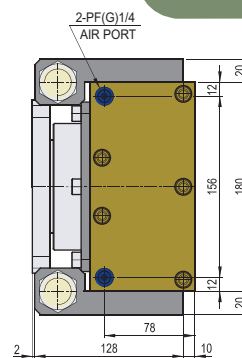
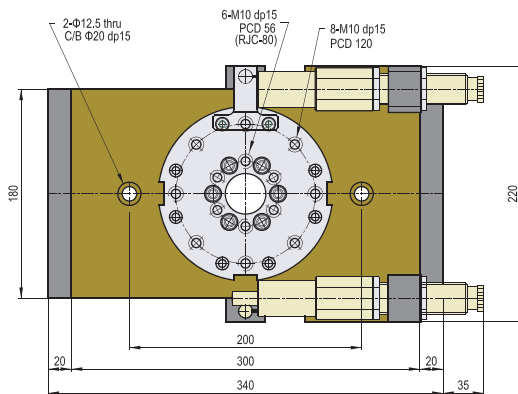

Notes

A large grid of dashed lines for writing notes, consisting of 20 columns and 30 rows. The grid is contained within a rounded rectangular border.